

BY10

EN

OPERATING MANUAL  
TYRE PRESSURE GAUGE



 TROTEC

**Table of contents**

**Notes regarding the operating manual**..... 2

**Safety** ..... 2

**Information about the device**..... 3

**Transport and storage**..... 4

**Operation** ..... 4

**Maintenance and repair** ..... 5

**Errors and faults**..... 5

**Disposal** ..... 5

**Notes regarding the operating manual**

**Symbols**

 **Warning of electrical voltage**  
 This symbol indicates dangers to the life and health of persons due to electrical voltage.

 **Warning**  
 This signal word indicates a hazard with an average risk level which, if not avoided, can result in serious injury or death.

 **Caution**  
 This signal word indicates a hazard with a low risk level which, if not avoided, can result in minor or moderate injury.

**Note**  
 This signal word indicates important information (e.g. material damage), but does not indicate hazards.

 **Info**  
 Information marked with this symbol helps you to carry out your tasks quickly and safely.

 **Follow the manual**  
 Information marked with this symbol indicates that the operating manual must be observed.

You can download the current version of the operating manual and the EU declaration of conformity via the following link:



BY10



<https://hub.trotec.com/?id=41249>

**Safety**

**Read this manual carefully before starting or using the device. Always store the manual in the immediate vicinity of the device or its site of use.**

-  **Warning**  
**Read all safety warnings and all instructions.** Failure to follow the warnings and instructions may result in electric shock, fire and/or serious injury. **Save all warnings and instructions for future reference.**
- This appliance can be used by children aged from 8 years and above and persons with reduced physical, sensory or mental capabilities or lack of experience and knowledge if they have been given supervision or instruction concerning use of the appliance in a safe way and understand the hazards involved. Children shall not play with the appliance. Cleaning and user maintenance shall not be made by children without supervision.
- Do not use the device in potentially explosive rooms or areas and do not install it there.
  - Do not use the device in aggressive atmosphere.
  - Do not immerse the device in water. Do not allow liquids to penetrate into the device.
  - The device may only be used in dry surroundings and must not be used in the rain or at a relative humidity exceeding the operating conditions.
  - Protect the device from permanent direct sunlight.
  - Do not remove any safety signs, stickers or labels from the device. Keep all safety signs, stickers and labels in legible condition.
  - Do not open the device.
  - Observe the storage and operating conditions as given in the Technical data chapter.

## Intended use

Only use the device to measure the tyre pressure on Schrader valves, as they are used on car and motorbike tyres and sometimes on bicycle tyres. Make sure to adhere to the measuring range specified in the technical data.

To use the device for its intended use, only use accessories and spare parts which have been approved by Trotec.

## Improper use

Do not use the device in potentially explosive atmospheres, for measurements in liquids or at live parts. Trotec accepts no liability for damages resulting from improper use. In such a case, any warranty claims will be voided. Any unauthorised modifications, alterations or structural changes to the device are forbidden.

## Personnel qualifications

People who use this device must:

- have read and understood the operating manual, especially the Safety chapter.

## Residual risks



### Warning

Risk of suffocation!  
Do not leave the packaging lying around. Children may use it as a dangerous toy.



### Warning

The device is not a toy and does not belong in the hands of children.



### Warning

Dangers can occur at the device when it is used by untrained people in an unprofessional or improper way! Observe the personnel qualifications!



### Caution

Keep a sufficient distance from heat sources.

### Note

To prevent damages to the device, do not expose it to extreme temperatures, extreme humidity or moisture.

### Note

Do not use abrasive cleaners or solvents to clean the device.

## Information about the device

### Device description

With this device you can determine the tyre pressure with digital precision and read it on the LC display.

The device is equipped with an integrated LED torch allowing you to determine the pressure or condition of the tyre in the dark.

### Device depiction

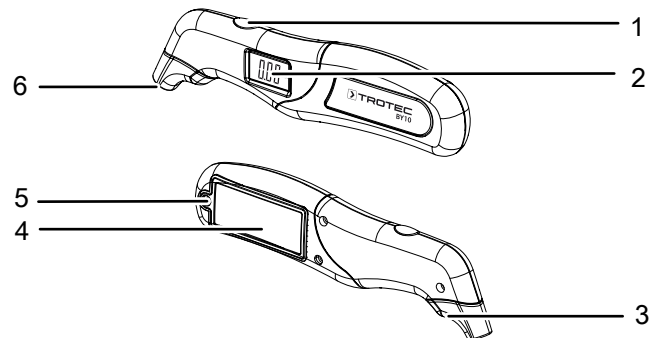

No.	Designation
1	Function button
2	LCD display
3	LED torch
4	Cover of the battery compartment
5	Screw, battery compartment cover
6	Measuring tip

### Display



No.	Designation
7	Indication of the unit: <i>psi</i>
8	Indication of the unit: <i>bar</i>
9	Indication of the unit: <i>kPa</i>
10	Measurement value display

**Technical data**

Parameter	Value
Model	BY10
Measuring range	5 to 100 psi 0.35 to 6.9 bar 35 to 690 kPa
Accuracy	±1 % / 0.5 psi ±1 % / 0.05 bar ±1 % / 3.5 kPa
Ambient conditions	0 °C to 50 °C (35 °F to 122 °F) with < 80 % RH
Power supply	2 x 1.5 V AAA batteries
Automatic switch-off	after approx. 45 seconds
Dimensions (length x width x height)	156 x 20 x 42 mm
Weight	82 g

**Scope of delivery**

- 1 x Tyre pressure gauge
- 2 x 1.5 V battery AAA
- 1 x Quick guide

**Transport and storage**

**Note**

If you store or transport the device improperly, the device may be damaged.  
Note the information regarding transport and storage of the device.

**Transport**

The manufacturer packed the device to the best of his abilities to protect it against transport damage.

When transporting the device, ensure dry conditions and and protect the device from external influences e.g. by using a suitable bag.

**Storage**

When the device is not being used, observe the following storage conditions:

- dry and protected from frost and heat
- protected from dust and direct sunlight
- The storage temperature is the same as the range given in the Technical data chapter.
- Remove the batteries from the device.

**Operation**

**Inserting the batteries**

**Note**

Make sure that the surface of the device is dry and the device is switched off.



**Info**

The battery tab (11) must be removed before initial use.

The battery must be changed if the indication on the LC display is only faintly visible during start-up.

1. Use a screwdriver and carefully remove the screw (5) at the rear of the device.
2. Remove the battery compartment cover (4).
3. Insert the batteries (2 batteries of type AAA) into the battery compartment with correct polarity.
4. Put the cover back onto the battery compartment (5).
5. Use a screwdriver to carefully tighten the screw (5).

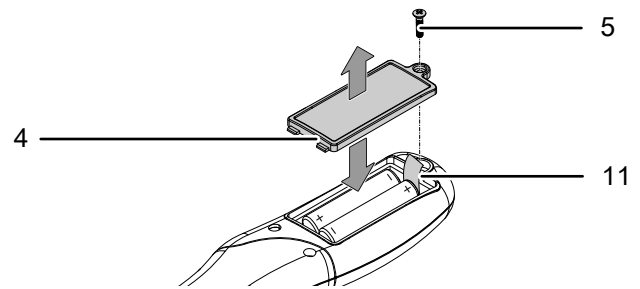

**Switch-on and air pressure measurements**



**Info**

The tyres should be cold for measurement! Warm tyres can distort the measurement result.

1. Briefly press the function button (1) to switch the device on.
  - ⇒ The LC display (2) is switched on and shows you the last measuring unit used.
  - ⇒ The LED torch (3) turns on.
2. Place the measuring tip (6) on the valve of your tyre. The LC display (2) now shows the tyre pressure in the previously selected measuring unit.

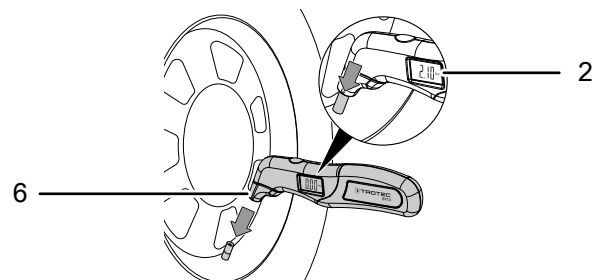

### Changing the unit psi / bar / kPa

Press the function button (1) again to switch between the units (psi - bar - kPa).

### Automatic switch-off

If the device is not used for 45 seconds, it switches off automatically.

### Switch-off

If you want to switch off the device directly, press and hold the function button (1) for approx. 3 seconds until the device is switched off.

## Maintenance and repair

### Cleaning

Clean the device with a soft, damp and lint-free cloth. Make sure that no moisture enters the housing. Do not use any sprays, solvents, alcohol-based cleaning agents or abrasive cleaners, but only clean water to moisten the cloth.

### Repair

Do not modify the device or install any spare parts. For repairs or device testing, contact the manufacturer.

## Errors and faults

The device has been checked for proper functioning several times during production. If malfunctions occur nonetheless, check the device according to the following list.

### Display segments are only faintly visible or the display lamp is only dimly lit:

- The battery power is too low, the battery must be changed

### The LED torch is only dimly lit or remains off

- The battery power is too low, the battery must be changed

## Disposal



The icon with the crossed-out waste bin on waste electrical or electronic equipment stipulates that this equipment must not be disposed of with the household waste at the end of its life. You will find collection points for free return of waste electrical and electronic equipment in your vicinity. The addresses can be obtained from your municipality or local administration. For further return options provided by us please refer to our website <https://de.trotec.com/shop/>.

The separate collection of waste electrical and electronic equipment aims to enable the re-use, recycling and other forms of recovery of waste equipment as well as to prevent negative effects for the environment and human health caused by the disposal of hazardous substances potentially contained in the equipment.



In the European Union, batteries and accumulators must not be treated as domestic waste, but must be disposed of professionally in accordance with Directive 2006/66/EC of the European Parliament and of the Council of 6 September 2006 on batteries and accumulators. Please dispose of batteries and accumulators according to the relevant legal requirements.

Trotec GmbH

Grebener Str. 7  
D-52525 Heinsberg

☎ +49 2452 962-400

☎ +49 2452 962-200

✉ [info@trotec.com](mailto:info@trotec.com)

[www.trotec.com](http://www.trotec.com)